

# Issho-tei | Take room

Located 2nd floor of the main building.

Offering the overlooking to the great Japanese garden.

Offering a spectacular view of the great "Daimonji", a large Japanese symbol that stands on Mt Myojogatake.

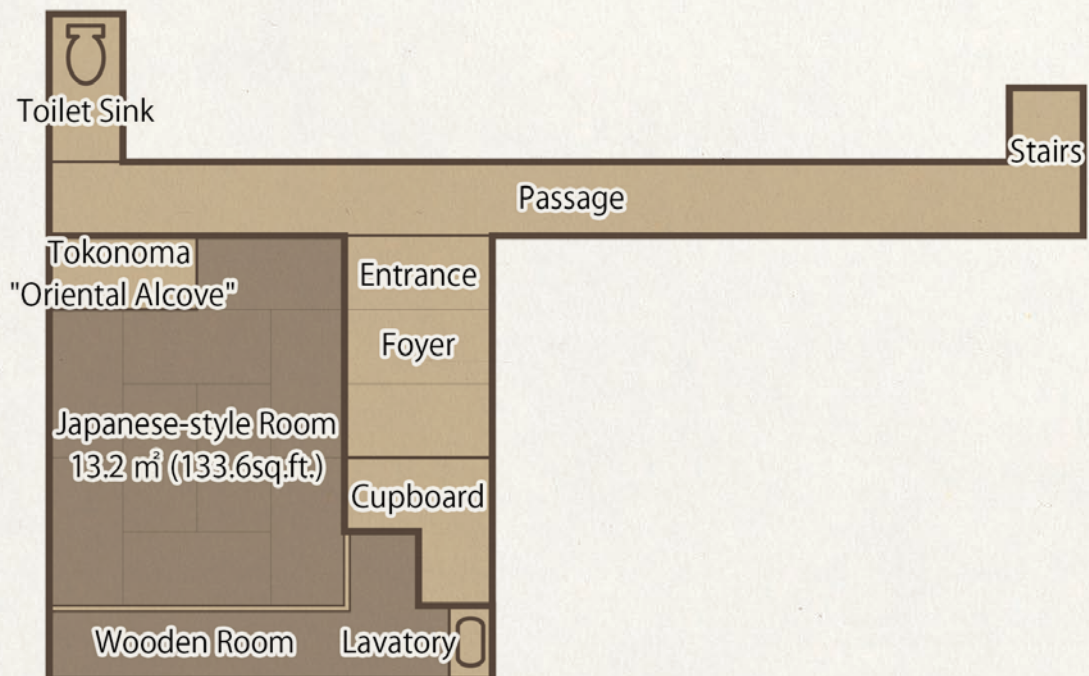

◆ Main Japanese style room with 8 tatami mats (13.2m<sup>2</sup>).

**Occupancy** 1 to 3 Persons